

CHAINTRACK

CTD 1500

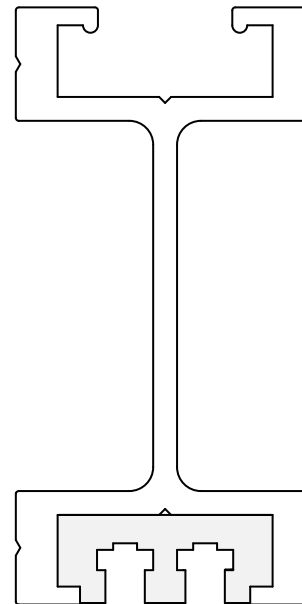

DISCLAIMER & COPYRIGHT

No part of this publication may be duplicated or edited in any form or by any means, including any type of electronic or mechanical method without prior written permission from ShowTex.



ShowTex NV and its employees are fully aware of their task to provide a reliable edition of this document. Nevertheless, they can accept no liability for (the direct or indirect consequences of) imperfections that might remain in this edition. The material in this manual is subject to change without notice.

All products from the ShowTex Rental range are supposed to be returned in the same state as they were rented. Please treat our products with care, allowing the next user to enjoy the products as much as you did. The rented products are internally checked according to the general rental conditions. Be sure to check our rental guidelines on our website before installing and using this product:

<http://www.showtexrental.com/showtex-rental-guidelines>.



Read and understand this user manual before installing and or operating the automatic reveal system. Failure to follow the instructions in this document could result in serious injury!



As a result of the above warning, any ShowTex product must be installed and operated by a qualified technician who has knowledge of its capabilities as well as its limitations.

Following the guidelines of this manual will reduce the risk of damaging the equipment or injuring yourself and the people around you. Damage to the system caused by any other method of installation than the one shown in this manual can only be repaired or fixed at the customer's expense.

CONTENT

Disclaimer & copyright	2
Intro	3
Warranty	3
Product description	3
Safety instructions	3
Max load & distance	4
Technical specifications	5
Components	5
Assembled single-track central overlap	9
Front, top and bottom plan view	9
Side and exploded view	10
Alternative mounting options	11
Using metric thread	11
Using ceiling Bracket	11
Installation	12
Necessary steps	12
Necessary tools	12
How to... ..	13
Determine the number of attachment points & the distance between them	13
Secure the hook clamps or ceiling brackets using the channel nut	14
Insert the joiner plates & green gliding profile	15
Install the CTD 1500 unit	16
Install control unit	16
Insert double chain	17
Insert the carrier & the runners	19
Insert the return pulley	19
Tension the chain to the correct level	19
Positioning the limit switches	20
Securing the limit switches	21
Connect the carriers to the chain	21
Place back the protective plate	21
Connect limit switches, CTD unit and remote control	22
Connect limit switches, CTD unit and remote control for DMX setup	23
Set up the DMX module	24
Install curtain	25
Care & maintenance	26
Trouble shooting	26
Contact & support	26

INTRO

Thank you for purchasing a ShowTex product.

Please take a moment to read this manual before installing or starting to use your new curtain track system. It contains important information regarding health and safety regulations and will guide you through the installation process safely and will show you how to use the system without injuring yourself or the people around you.

WARRANTY

ShowTex warrants that its mechanical/technical products, when delivered in new condition, in original packaging, sold directly and used in normal conditions, are free from any defects in manufacturing, materials and workmanship. The warranty shall only apply if the mandatory preventive maintenance actions as described in the technical documentation have been executed by skilled people. Warranty starts on invoice date for a period of 24 months.

Please read the entire warranty declaration on our website www.showtex.com before installing & using this product.

PRODUCT DESCRIPTION

Chaintrack is the perfect combination of reliable precision movement and track durability. The profile allows for double chain installation when curtains need to move in two different directions (left and right). Attach your curtains and set pieces directly to the chain for a continuously moving flat background allowing for sharp turns of up to 180° in as little as a 5 cm radius. Ideal for storage in compact spaces and when you want to show both sides of a curtain.

SAFETY INSTRUCTIONS



Do not exceed the maximum carrying capacity of the track and its components. Be sure to check if the capacity of the suspension points corresponds to the weight of the track and the items to be suspended from the track (***see chapters 'technical specifications' and 'max. load & distance'***)

Do not exceed the maximum distance between each suspension point. Provide extra points in the curtain storage area to support the accumulated weight of the curtain when gathered together. Be sure to refer to the technical datasheet for more detailed information (***see chapter 'max. load & distance'***)

Do not allow any item to be operated or used when in doubt about the safety or good working order to avoid accidents and injuries. Most accidents are the result of lack of training, carelessness and overconfidence, do not assume anything.

Do not use this rail system for any other purpose than hanging and moving stage curtains or light-weight decorative elements. Only combine this rail system with parts and accessories from the ShowTex curtain track range.

Disassembly must be carried out under the same conditions and following the same steps as assembly but in reverse order. Remove all curtains or other suspended items before removing tracks from their permanent location. Disconnect all parts before removing tracks. Never remove in one piece.



To prevent electrocution and contact with moving parts, disable the power supply before carrying out any work on the units.

CTD units must be installed with a corresponding earth wire of the same section as the power cable. Installation and operation must take place in a dry frost-free environment.

A sudden unexpected start-up of the system by not disabling the power in both the standard and CTD units causes a risk to the operator.

Be aware that the motion system keeps moving as long as the power is on. If a problem occurs, anything in its path can cause damage to the moving curtain until the master or overlap carriers reach the limit switch or the motor unit is shut down.

MAX LOAD & DISTANCE

Never exceed the maximum distance and approved loads shown in the drawing and graph on this page.

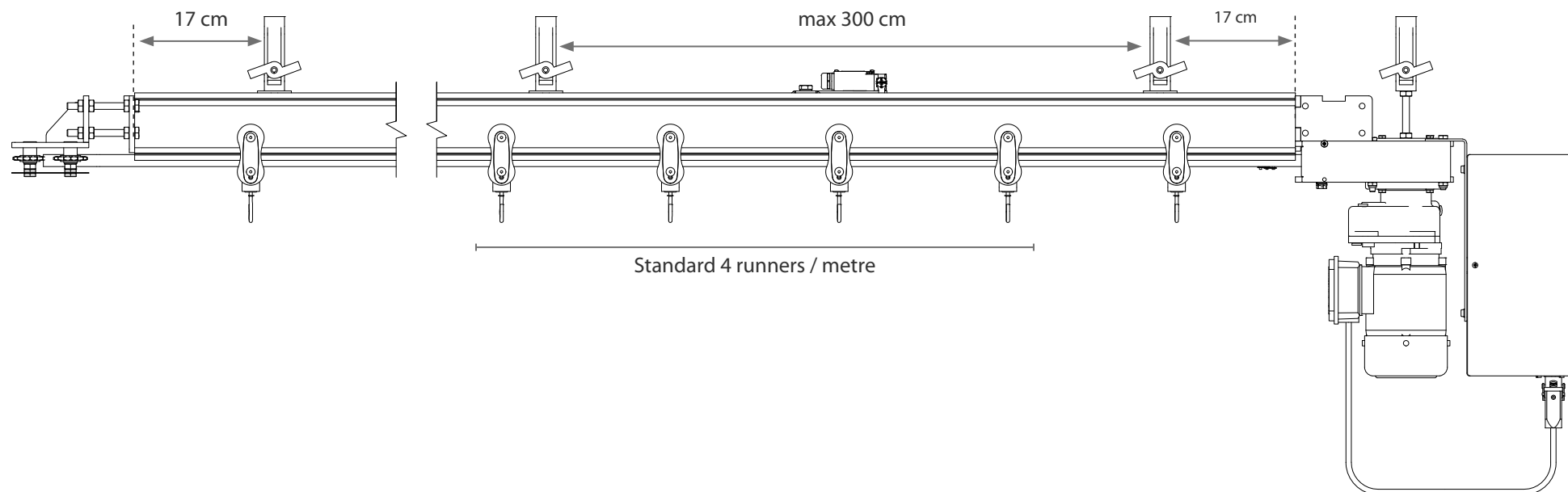

*Provide extra suspension points in the curtain storage area to support the accumulated weight of the curtain when gathered together!
Track load capacities have been calculated using safety factor 2, runners & carriers are calculated without safety factor.
Apply the required safety factor according to the standards pertaining to your application.*

Name	Art. No	SWL	Point load between 3 m suspension points	Uniformly distributed load between 3 m suspension points
Track	8080 0001 6007	x	100 kg	67 kg/m • 200 kg
Ball Raced Runner	8070 0209 0257	25 kg	x	x
Scenery Carrier 100kg	8070 0230 1037	100 kg	x	x
Scenery Carrier 350kg	8075 0230 3507	350 kg	x	x

TECHNICAL SPECIFICATIONS

COMPONENTS

The following components are parts of the ChainTrack rail system.

CAUTION! The components included in your shipment depend on the specific situation in which you want to use this system.

For more technical information, please refer to the technical datasheet.

LEGEND

/m	Weight per metre
/p	Weight per piece
/s	Weight per set

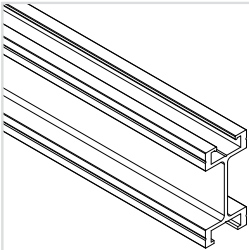
	TRACK			
	Art. No.	Colour	Weight	Lenght
	8080 0001 6007	Black	3.24 kg/m	600 cm

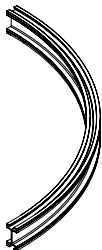
	CURVED TRACK		
	Art. No.	Colour	Weight
	8080 0001 6907	Black	5.09 kg/p
	Info Minimum radius 50 cm		

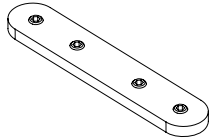
	TRACK JOINER SET		
	Art. No.	Colour	Weight
	8075 0042 1807	Black	0.37 kg

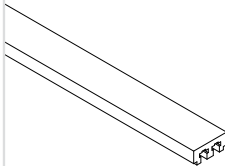
	SLIDING PROFILE FOR CHAIN			
	Art. No.	Colour	Weight	Lenght
	8080 0020 0069	Green	0.41 kg/s	200 cm

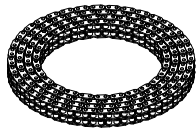
	CHAIN			
	Art. No.	Colour	Weight	Lenght
	8080 0355 0000	Black	1.23 kg/m	500 cm

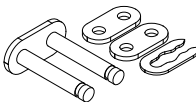
	CHAIN LOCK		
	Art. No.	Colour	Weight
	8080 0365 0000	Black	0.01 kg/s

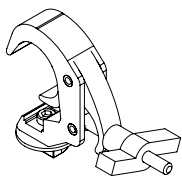

HOOK CLAMP + CHANNEL NUT

Art. No.	Colour	Weight	SWL
8080 0680 0007	Black	1.22 kg	100 kg

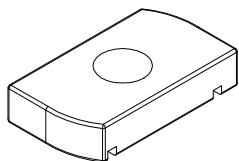

CHANNEL NUT M10

Art. No.	Colour	Weight
8700 9224 0101	Galvanised	0.18 kg

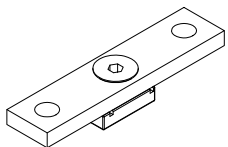

CEILING BRACKET WITH CHANNEL NUT 10

Art. No.	Colour	Weight
8075 0110 0007	Black	0.18 kg



BALL RACED RUNNER

Art. No.	Colour	Weight	SWL
8070 0209 0257	Black	0.28 kg	25 kg

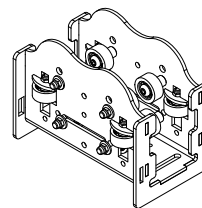

SCENERY CARRIER 100 KG

Art. No.	Colour	Weight	SWL
8070 0230 1037	Black	2.32 kg	100 kg

Info

For bends custom modifications are needed

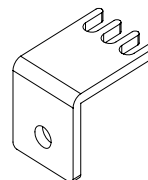

RUNNER CHAIN LINK 100 KG

Art. No.	Colour	Weight
8080 0041 0397	Black	0.06 kg

Info

For use with 100 kg scenery carrier

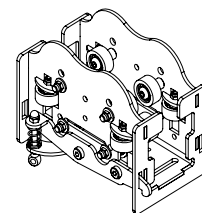

QUICK RELEASE RUNNER 100 KG

Art. No.	Colour	Weight	SWL
8070 0230 1067	Black	3.70 kg	100 kg

Info

Min radius 600 cm

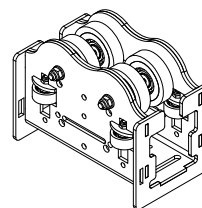

SCENERY CARRIER 350 KG

Art. No.	Colour	Weight	SWL
8075 0230 3507	Black	3.70 kg	350 kg

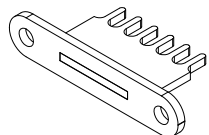

RUNNER CHAIN LINK 350 KG

Art. No.	Colour	Weight
8080 0041 0387	Black	0.138 kg

Info

For use with 350 kg scenery carrier
For bends custom modifications are needed

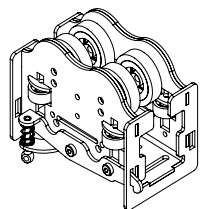

QUICK RELEASE RUNNER 350 KG

Art. No.	Colour	Weight	SWL
8075 0230 3537	Black	3.70 kg	350 kg

Info

Min radius 600 cm

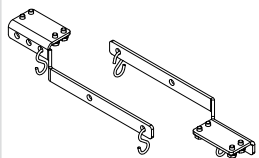

OVERLAP ARM SET

Art. No.	Colour	Weight
8070 0241 0017	Black	0.60 kg/s

Info

2 pieces, with 4 s-hooks

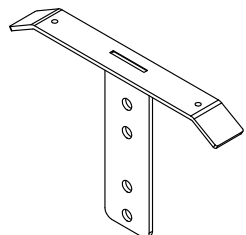

SKI FOR LIMIT SWITCH

Art. No.	Colour	Weight
8075 0770 0017	Black	0.232 kg

Info

Attach to carrier

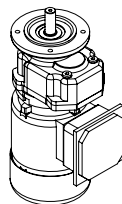

CTD 1500

Art. No.	Colour	Weight
8050 0713 2257	Black	9.19 kg

Info

120 W • 3 x 230 VAC • 0.69 A (refer to the tds for more information)

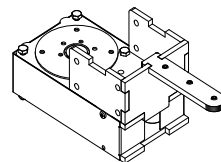

CHAIN TRANSMISSION

Art. No.	Colour	Weight
8080 0486 0037	Black	0.6 kg

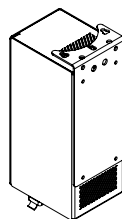

CTD 1500 CONTROL UNIT

Art. No.	Colour	Weight
8050 0751 1507	Black	6.64 kg

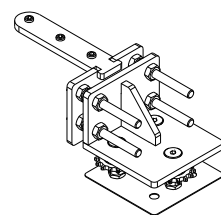

RETURN PULLEY

Art. No.	Colour	Weight
8080 0485 0027	Black	1.81 kg

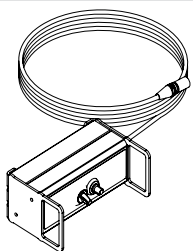

CTD 1500 REMOTE UNIT

Art. No.

8050 0766 0040

Weight

1.74 kg

Info

2m control cable included

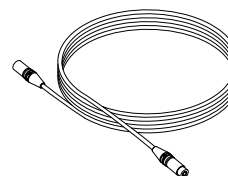

EXTENSION CABLE

Art. No.

8140 7202 2500

Weight

2.60 kg

Lenght

25 m

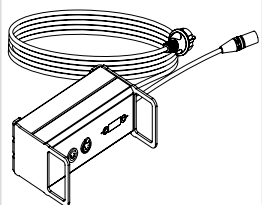

CTD 1500 DMX BASIC MODULE

Art. No.

8050 0766 0300

Weight

1.92 kg

Info

2 metre power and 2 metre control cable included.

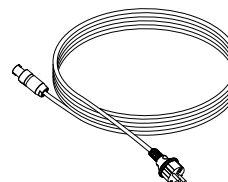

POWER CABLE

Art. No.

8150 0912 0027

Weight

0.43 kg

Lenght

2 m

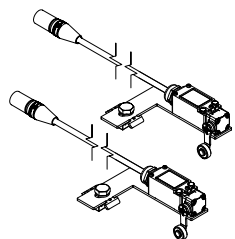

LIMIT SWITCH SET

Art. No.

8050 0770 0013

Weight

0.85kg/p

ASSEMBLED SINGLE-TRACK CENTRAL OVERLAP

FRONT, TOP AND BOTTOM PLAN VIEW

1. Front view

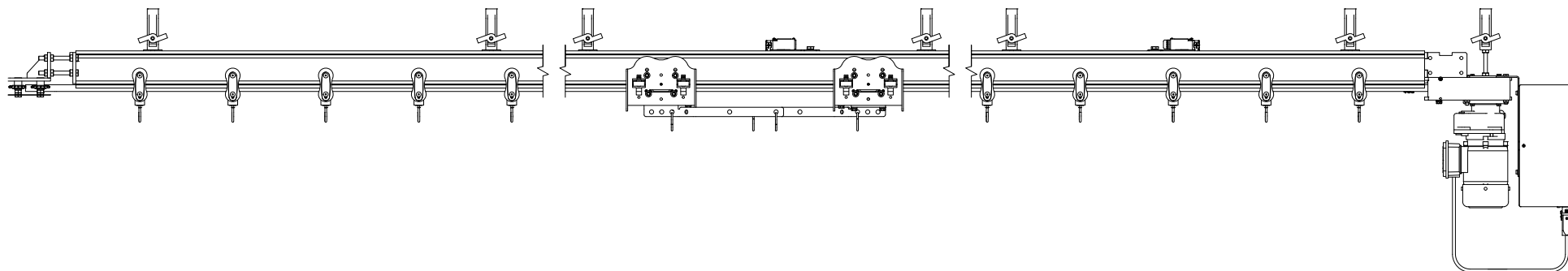

2. Top view

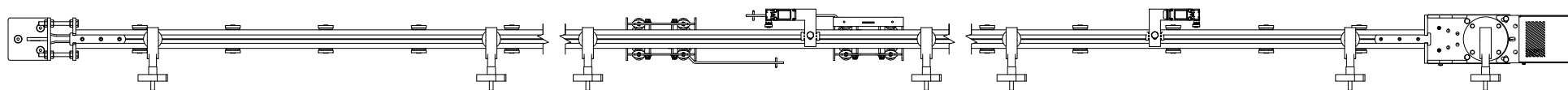

3. Bottom plan view

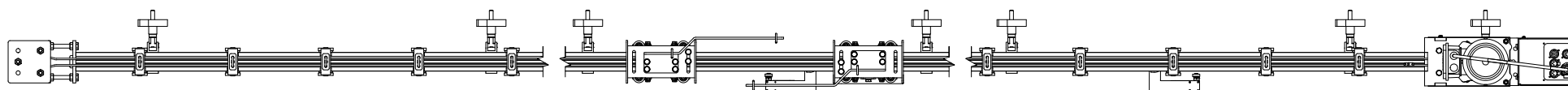

SIDE AND EXPLODED VIEW

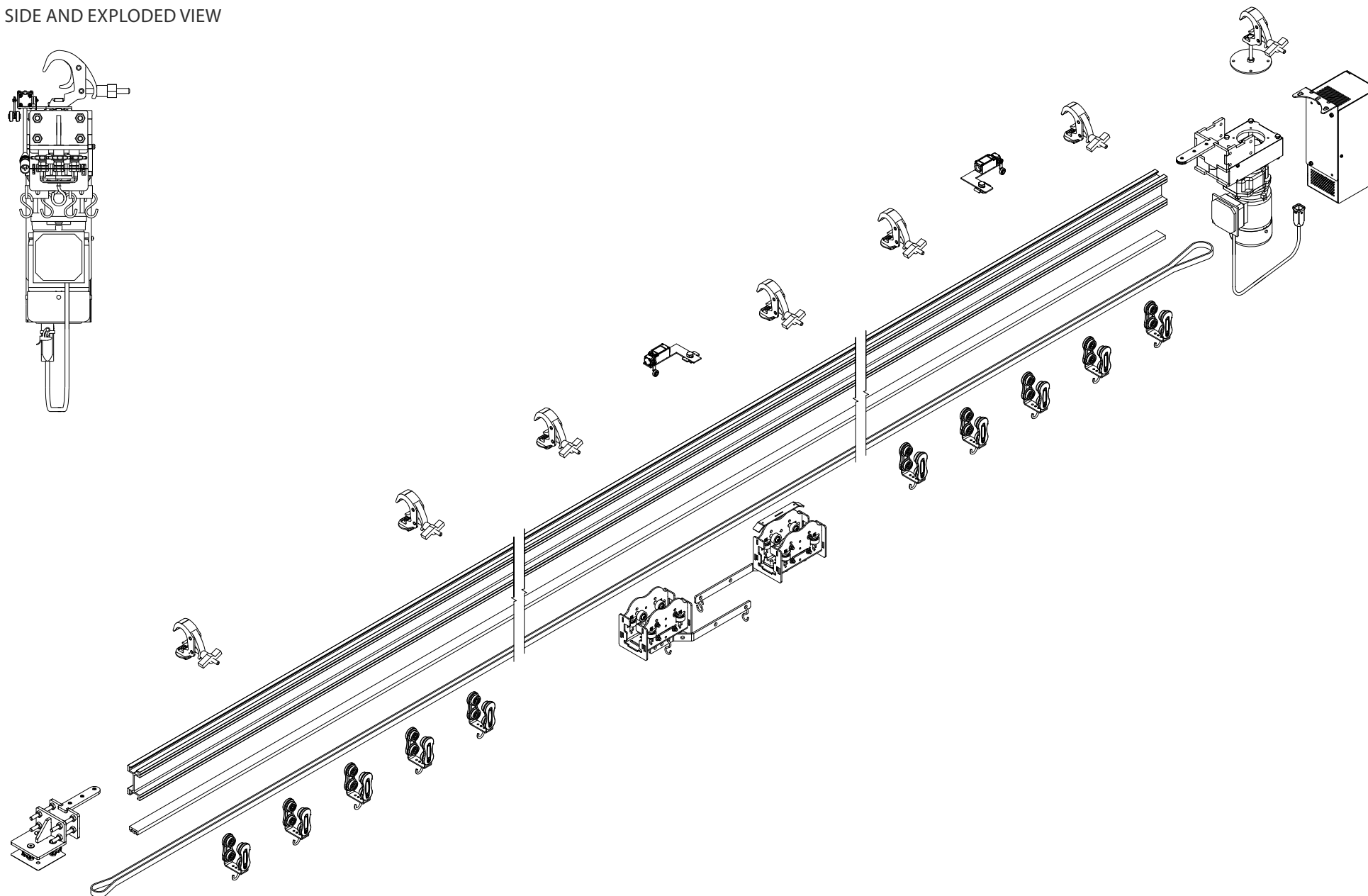

ALTERNATIVE MOUNTING OPTIONS

USING METRIC THREAD

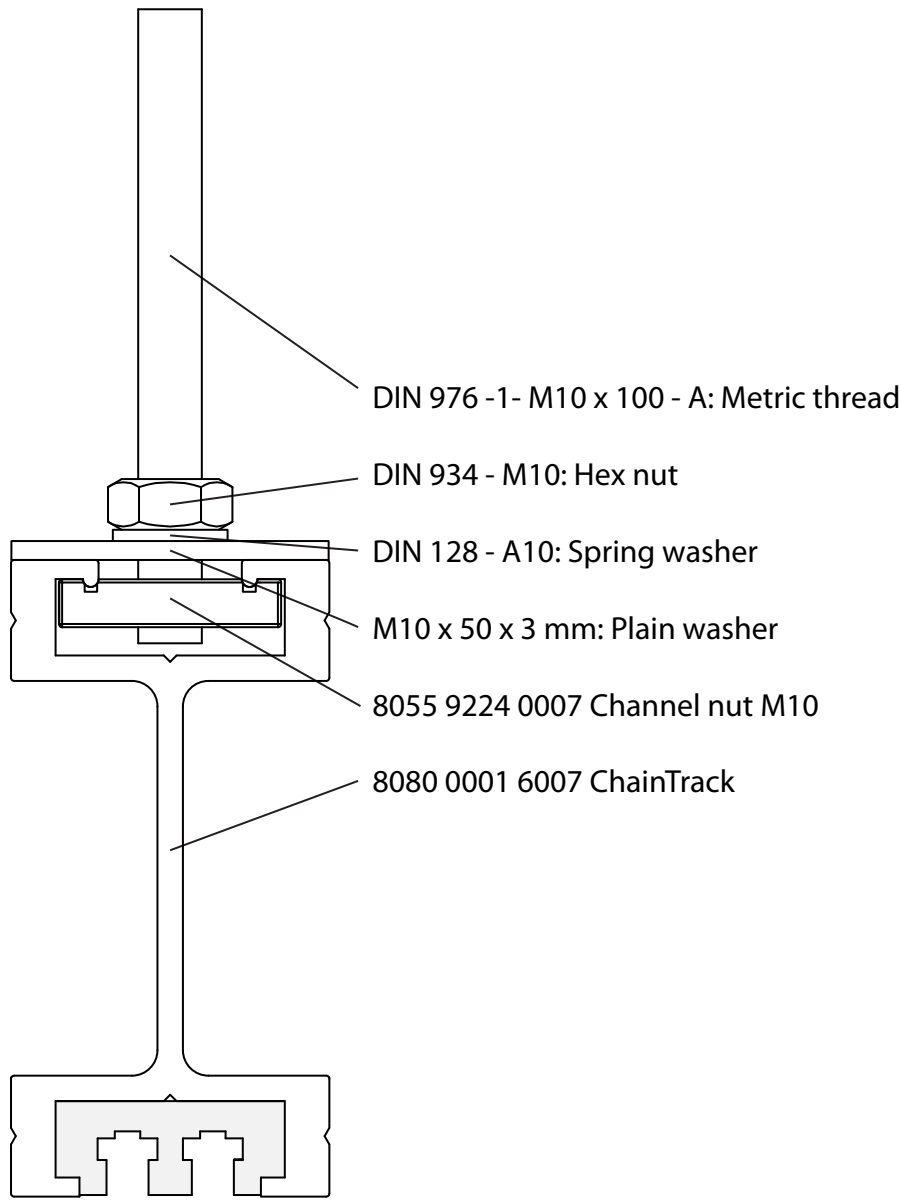

USING CEILING BRACKET

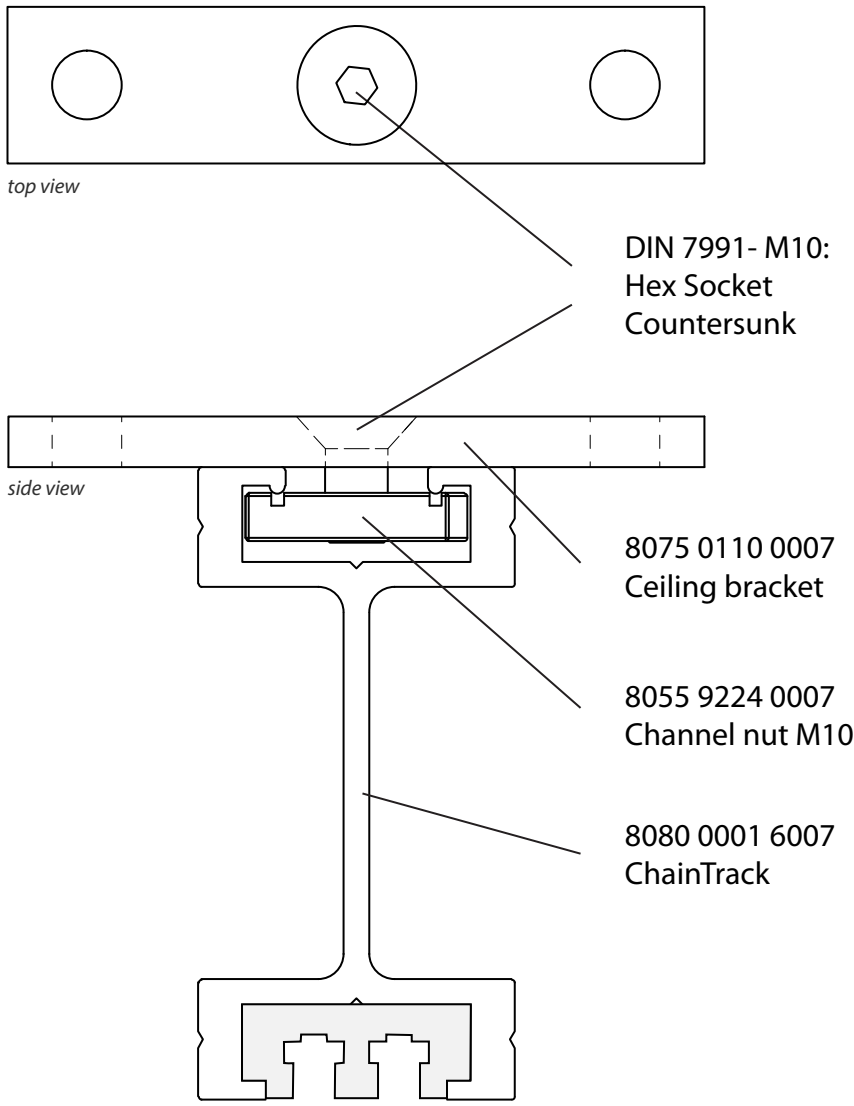

INSTALLATION

This chapter provides all required information and steps necessary for installing a ChainTrack motorised by a CTD1500 motor unit. Note that a certain technical knowledge and experience are required to understand this guide and install this product.



BE SURE TO CHECK THE “HOW TO ...” CHAPTER FOR CORRECT INSTALLATION OF THE SYSTEM.

NECESSARY STEPS

1. Determine attachment points & distance between them.
2. Place hook clamps on the rail & secure by hand.
3. Place joiner plates inside the top of the rail sections & secure by hand.
4. Place an uneven amount of gliding profile into the bottom slit of the first rail section.
5. Place an even amount of gliding profiles into the bottom slit of all other rail sections.
6. Mount first rail section onto supporting structure & secure clamps to rail.
7. Mount second rail onto supporting structure & secure joiner sets.
8. Slide the green profile into the first rail section until it's overlapping the rail connection.
9. Repeat steps 7 & 8 for all other rail sections.
10. Cut the remaining gliding profile to the correct length and place it into the last rail section.
11. Check all clamps and joiner plates and secure if necessary.
12. Prepare & install the CTD 1500 motor unit.
13. Insert the double chain into the green gliding profile.
14. Connect the chains using the chain locks.
15. Prepare the scenery carrier & insert together with the runners.
16. Install the return pulley & put the chain tensioner to smallest position.
17. Guide the chain around the pulley & cut the last piece of chain to the correct length.
18. Close the chain loop with a chain lock.
19. Tension the chain at level of the return pulley.
20. Position & install the limit switches accordingly.
21. Bring the scenery carriers to the centre position of the rail or stage.
22. Connect the scenery carriers to the chain using the chain link.
23. Connect limit switches, CTD 1500 unit & remote accordingly.
24. Connect DMX & set DMX address (optional).
25. Test run the system without curtain & check curtain width.
26. Mount the curtain onto the rail & perform 2nd test run.



When installing a rail between 2 walls, don't forget to insert all runners & master carriers and attach head & return pulley before securing the rail in the supporting structure!

NECESSARY TOOLS

The following tools are needed to install the ChainTrack & CTD 1500 motor.

	Allen key 5
	Allen key 6
	Allen key 8
	Wrench 10
	Wrench 13
	Wrench 17
	Hammer
	Hacksaw
	Long-nose pliers
	Hand Punch 3mm
	Chain Breaker
	Chain Tensioner

HOW TO...

DETERMINE THE NUMBER OF ATTACHMENT POINTS & THE DISTANCE BETWEEN THEM

Determine the amount of attachment points you need and calculate the distance between them by following the steps outlined below.
Never exceed the maximum distance of 200 cm between each point!

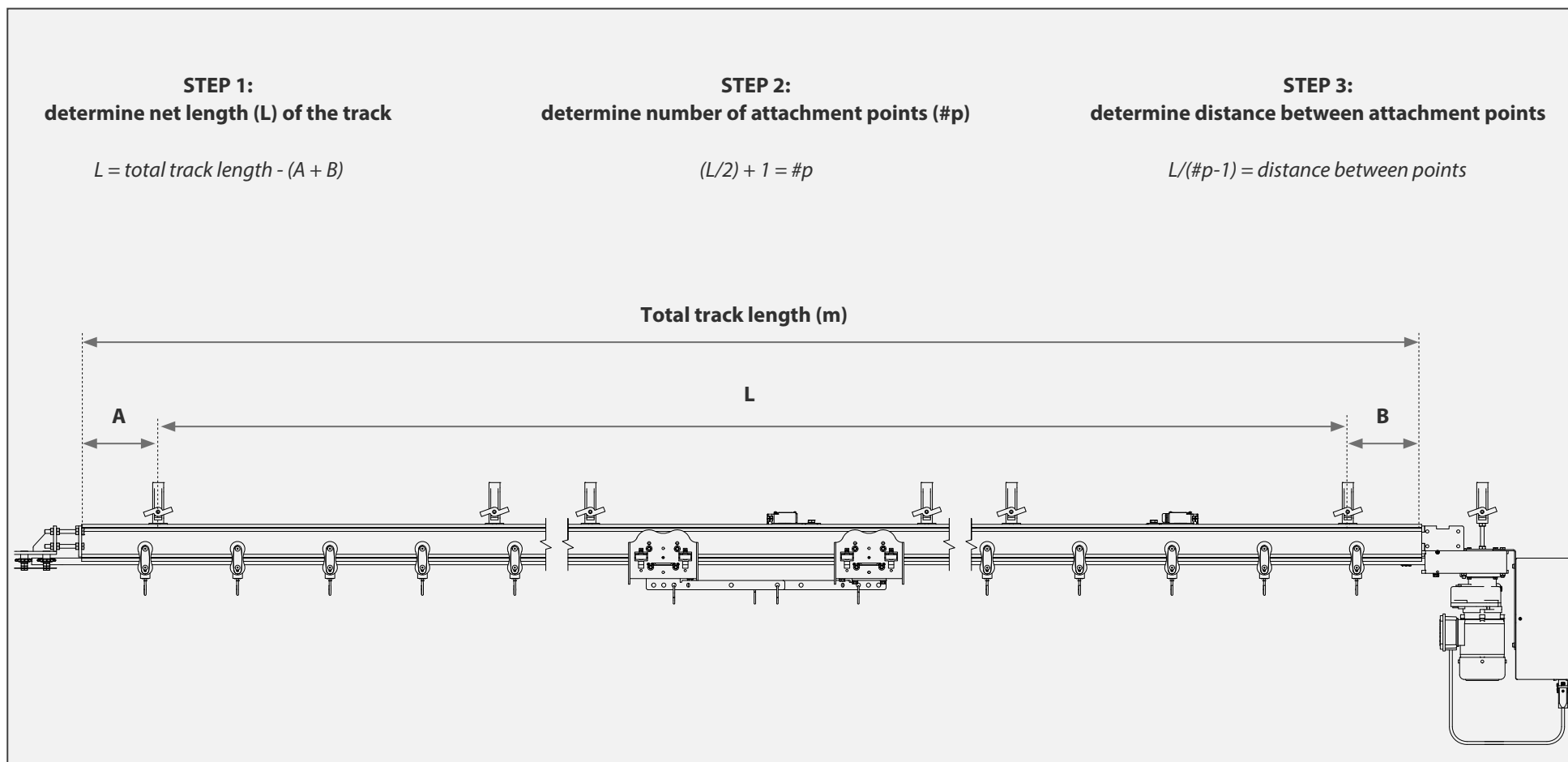

When connecting two pieces of rail, always place an extra suspension point within 20 cm of the joiner set!

SECURE THE HOOK CLAMPS OR CEILING BRACKETS USING THE CHANNEL NUT

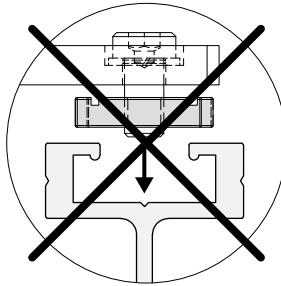
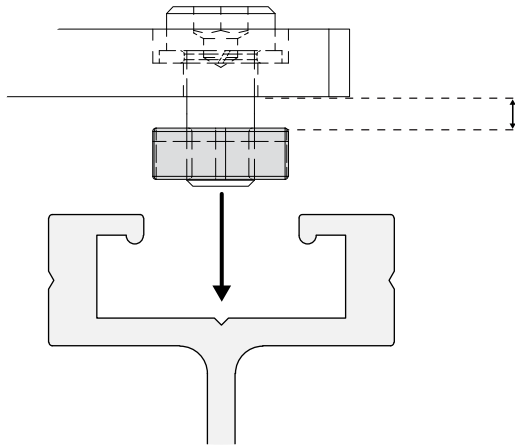

1: Turn the channel nut until it fits into the track profile and insert it into the rail.

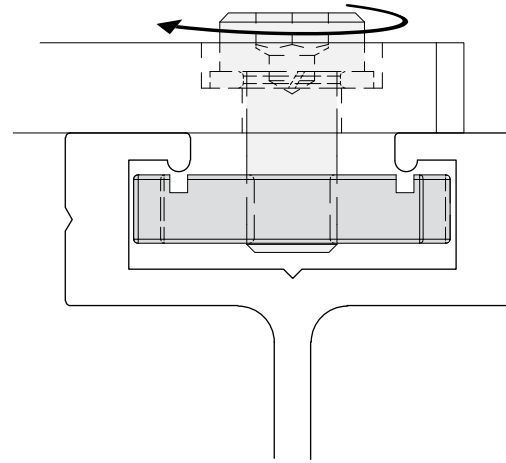

3: Keep the channel nut in place whilst tightening the socket screw or bolt.

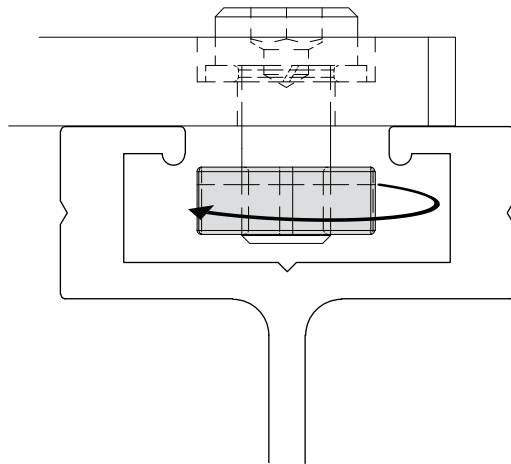

2: Rotate the channel nut a quarter turn.

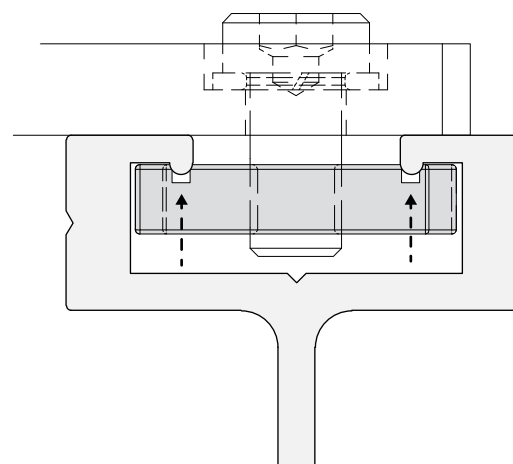

4: By turning the socket screw or bolt, the channel nut will lock itself into the profile of the track.

INSERT THE JOINER PLATES & GREEN GLIDING PROFILE

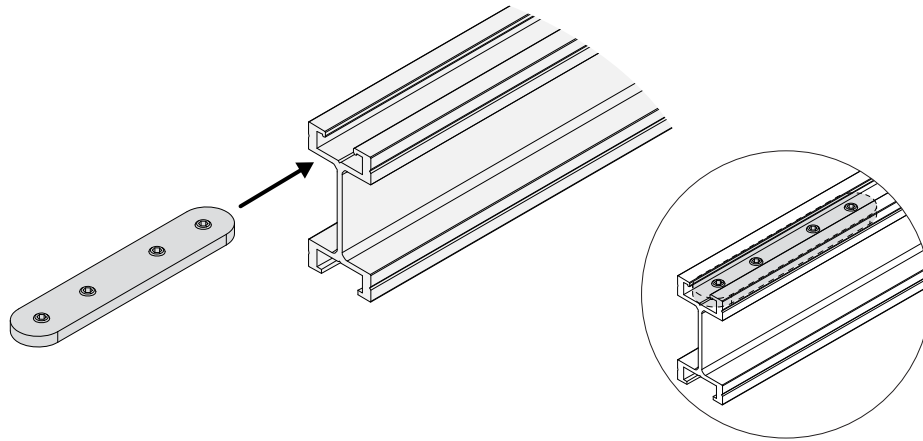

- 1: Slide the joiner plates all the way into the top slits of the rail sections.
- 2: Don't secure the plates for now.

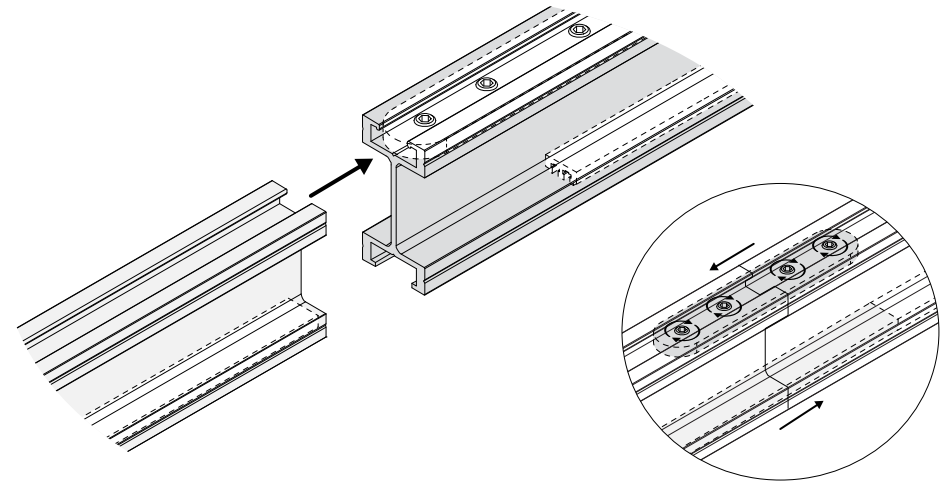

- 5: Align the outer ends of the rail sections for easy connection.
- 6: Use the joiner plates and the sliding profile to secure.

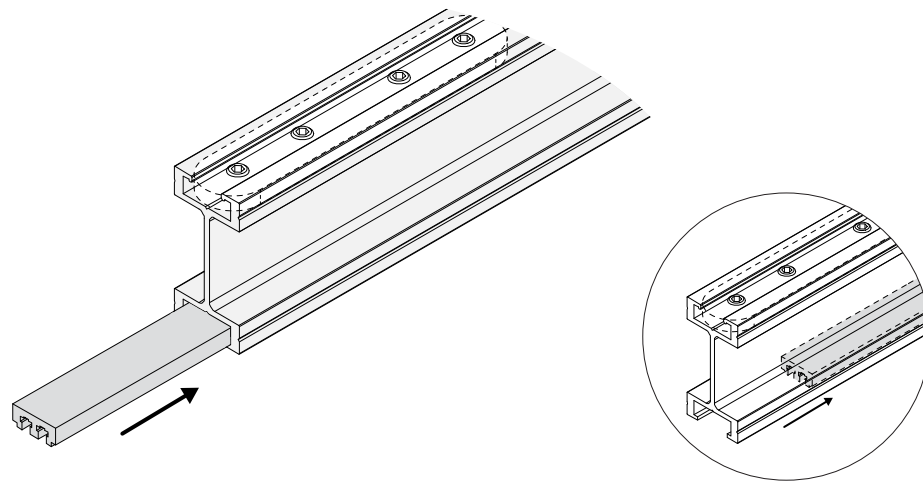

- 3: Slide 5 m of green profile all the way into the bottom slit of the 6 m rail section.
- 4: Slide an even amount of green profile into the other 6 m rail sections.

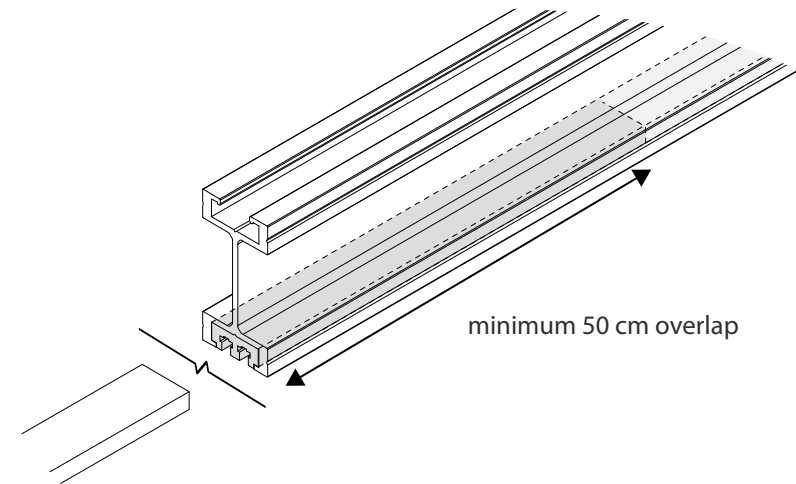

- 7: Repeat step 5 & 6 until all rail sections are connected.
- 8: Cut the remaining gliding profile to length & insert into the last rail section.

INSTALL THE CTD 1500 UNIT

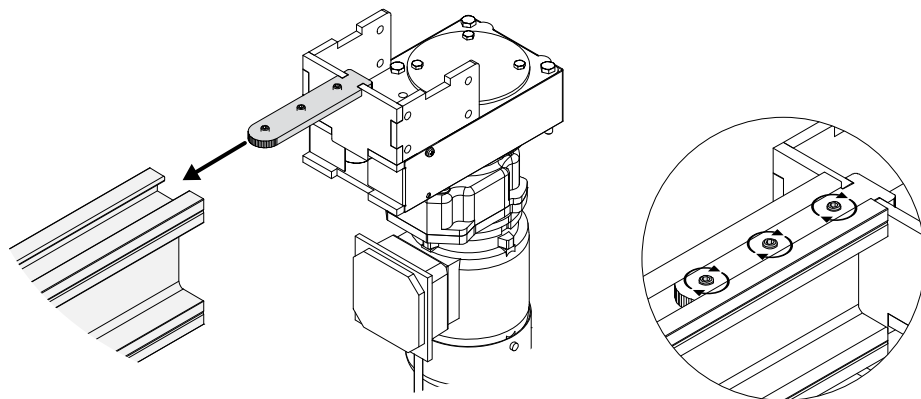

- 1: Slide the motor unit into the top slit of the rail & open the transmission box.
- 2: Tighten both bolts, give an extra 1/2 turn to secure.

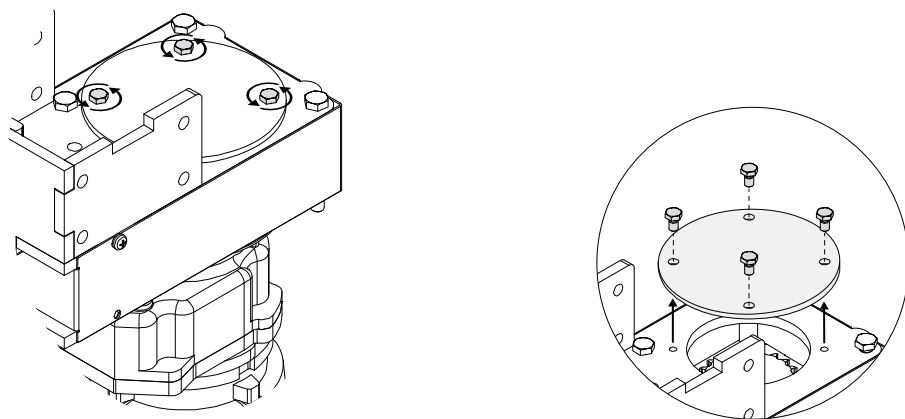

- 3: Loosen the bolts of the top plate of the chain transmission.
- 4: Remove the top plate.

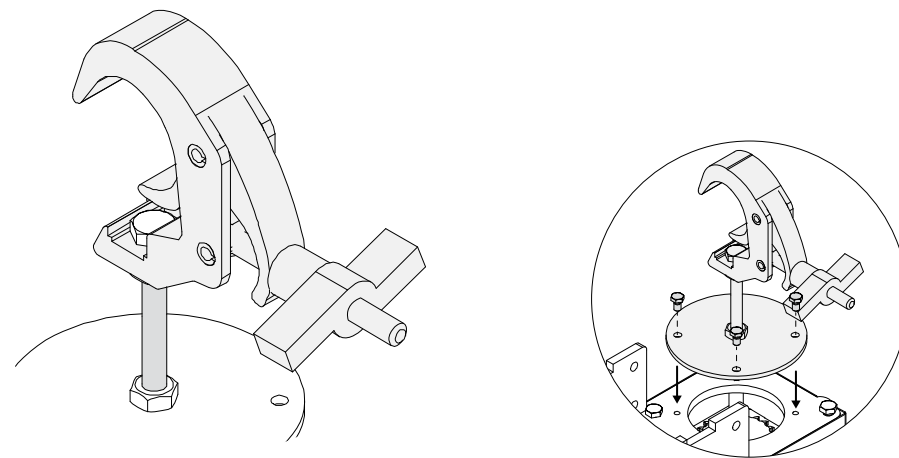

- 5: Attach a clamp to the top plate using a threaded rod.
- 6: Mount the plate back on the transmission & secure to mounting structure.

INSTALL CONTROL UNIT

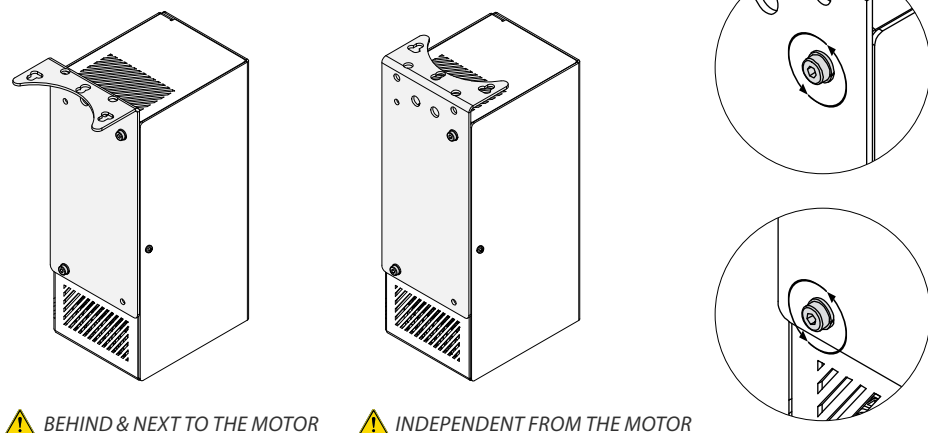

⚠ BEHIND & NEXT TO THE MOTOR ⚠ INDEPENDENT FROM THE MOTOR

- 1: Choose where you want the control unit to go in relation to the motor.
- 2: Loosen both nuts to adjust the mounting plate if necessary.

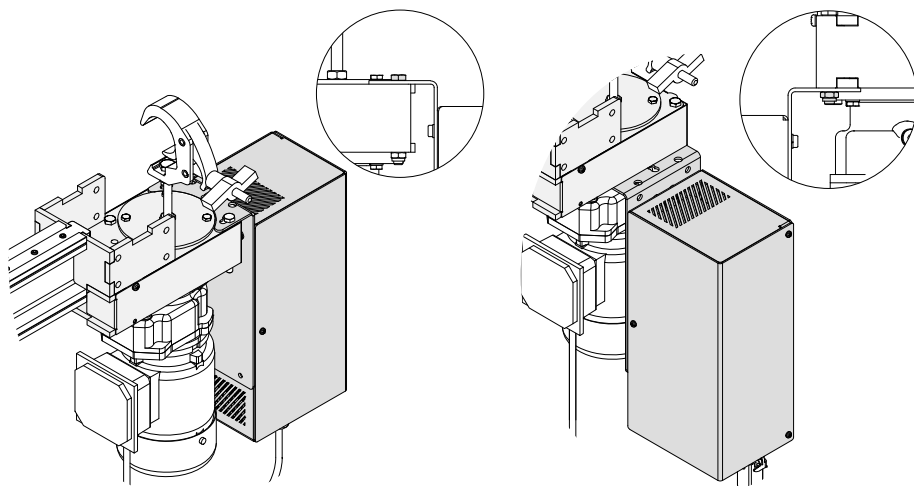

3: Mount the control unit onto the motor.

4: Tighten the bolts (M8), give an extra 1/2 turn to secure.

⚠ CONTROL UNIT INDEPENDENT FROM THE MOTOR

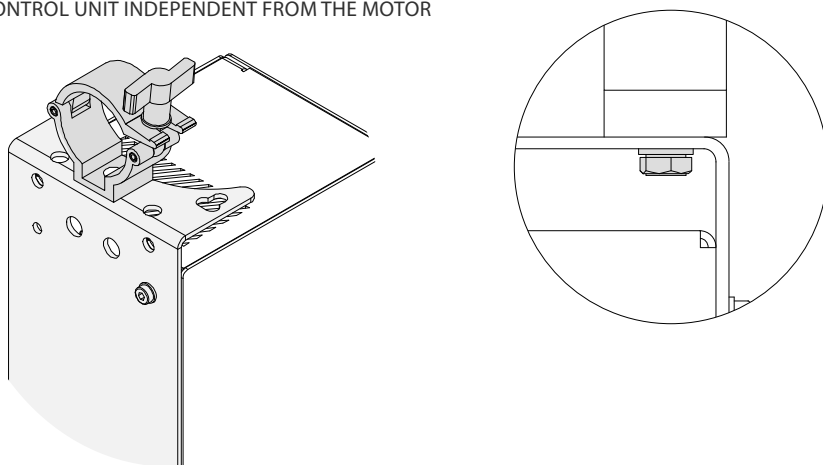

5: Add an extra clamp if you install the control unit independent from the motor.

6: Tighten the bolt (M10), give an extra 1/2 turn to secure.

INSERT DOUBLE CHAIN

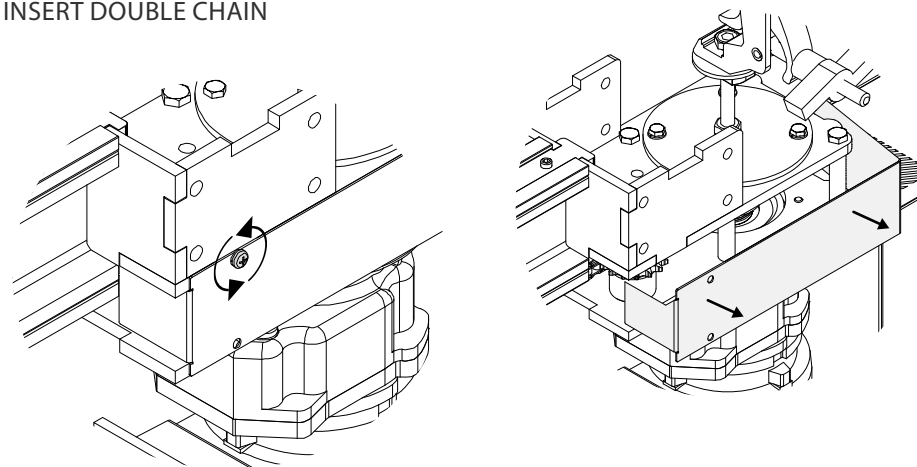

1: Loosen the screws.

2: Remove the protective plate from the chain transmission.

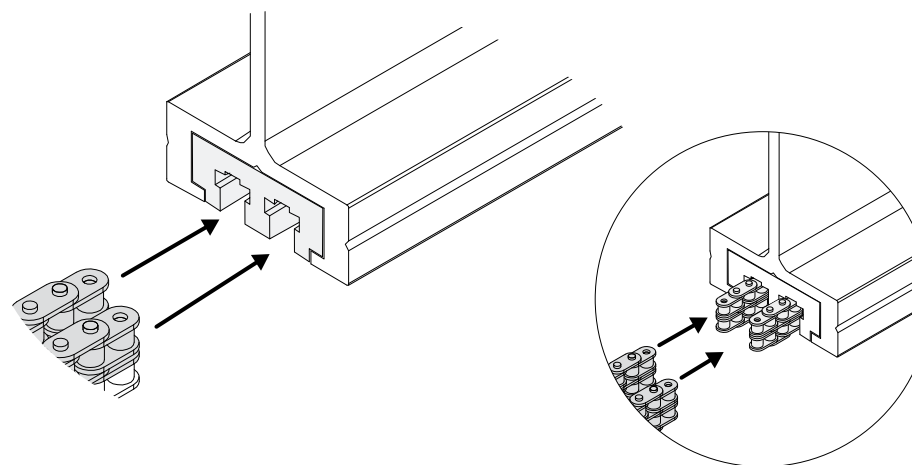

3: Pull the first 5 m chain lengths into the channels of the green sliding profile.

4: Leave the outer ends outside the rail & connect with the next chain lengths.

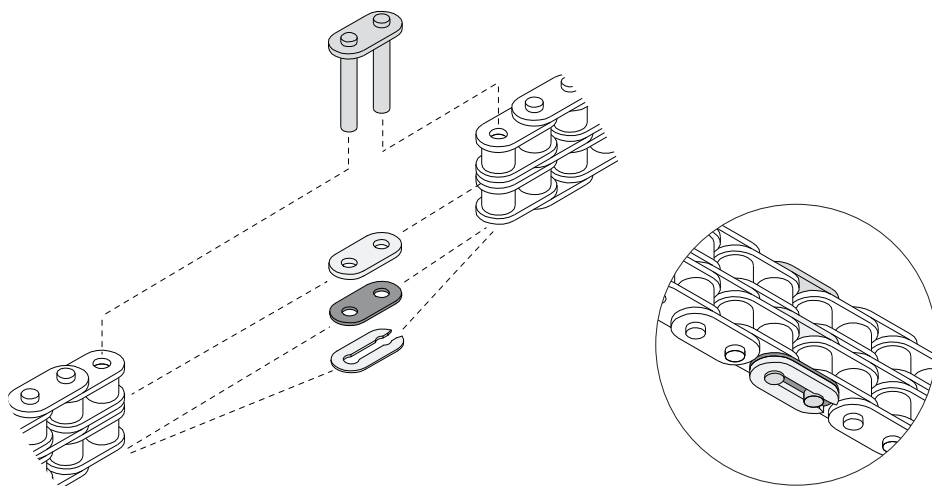

5: Connect the chains using the chain locks, mind the order of the plates.

6: Use a long-noise pliers to secure the chainlink.

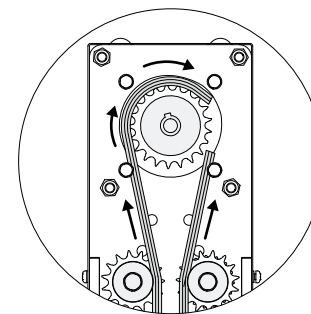
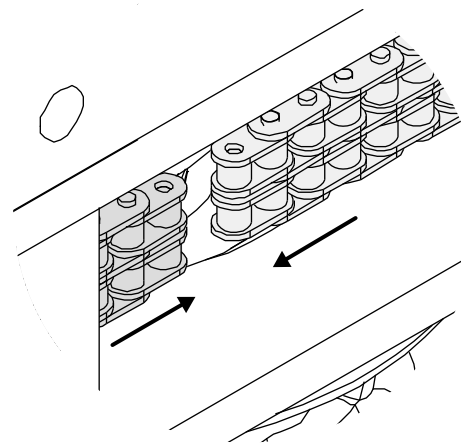

9: Bring the outers ends of the chains together at the motor side.

10: Guide them around the sprocket wheels & connect using a chain lock.

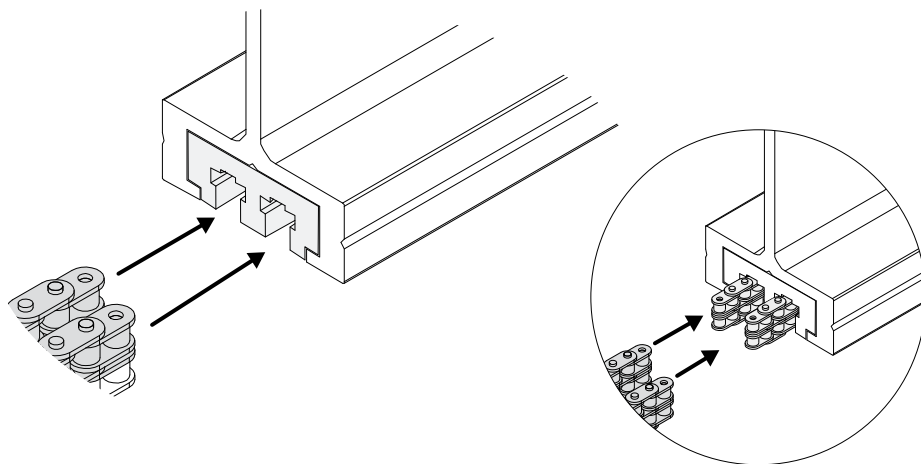

7: Repeat the previous steps untill all chain lengths are used.

8: Don't cut the chain to the correct length at this moment.

INSERT THE CARRIER & THE RUNNERS

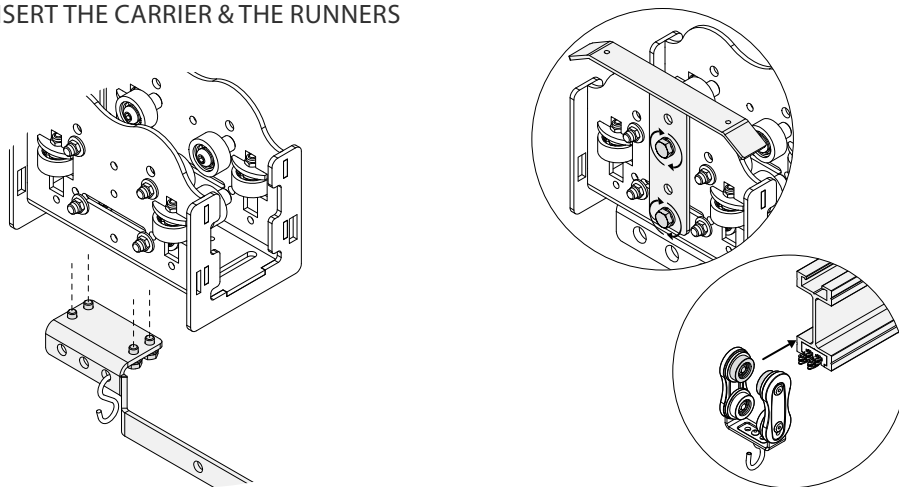

- 1: Attach the overlap arms to the carriers when using a central overlap system.
- 2: Attach the ski to one of the scenery carriers & insert together with the runners.

INSERT THE RETURN PULLEY

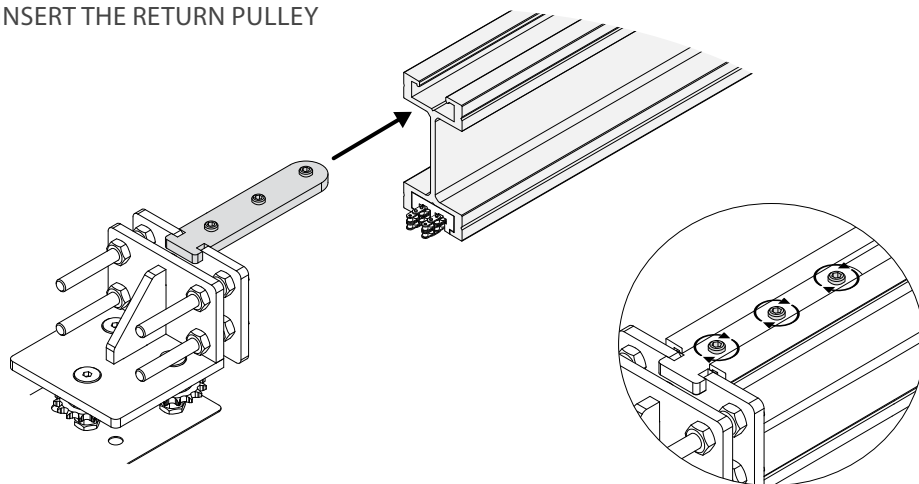

- 1: Slide the pulley into the top slit of the rail.
- 2: Tighten both bolts, give an extra 1/2 turn to secure.

TENSION THE CHAIN TO THE CORRECT LEVEL

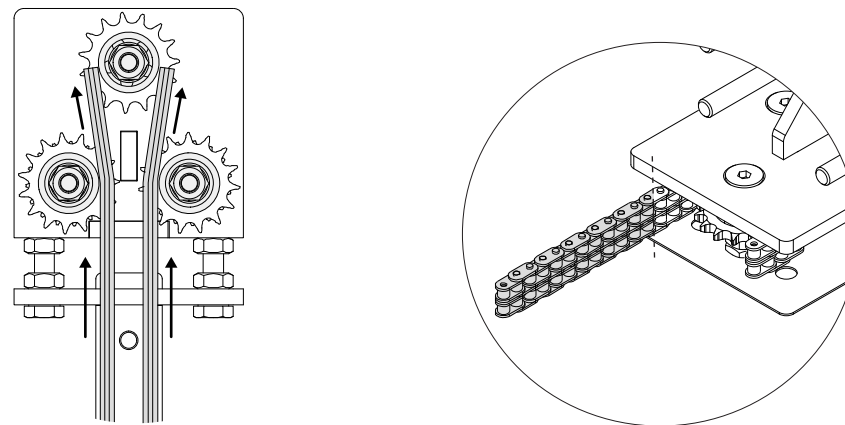

- 1: Guide the outer end of the chains around the sprocket wheels of the pulley.
- 2: Cut the chains to the correct length.

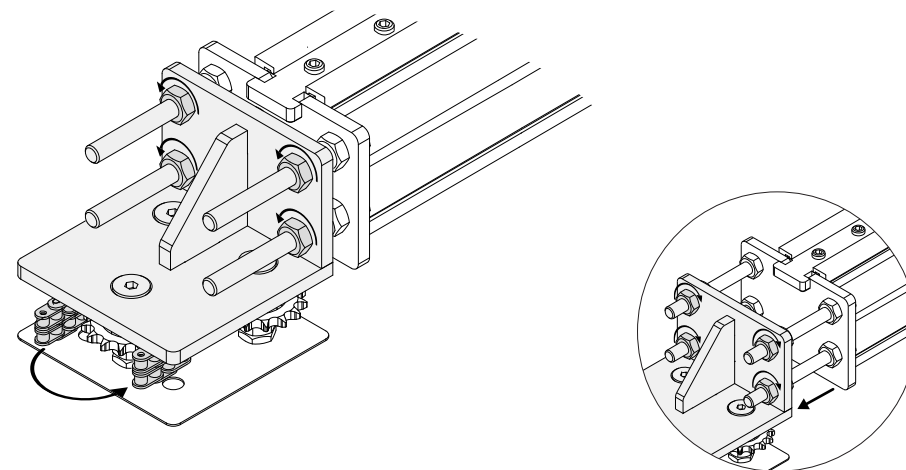

- 3: Close the chain loop using a chain lock as shown on page 18.
- 4: Tension the chain by pushing the return pulley backwards.

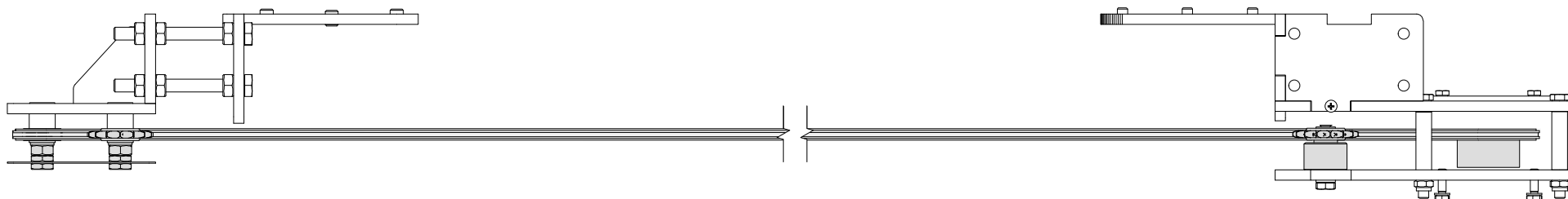

5: Check if the guiding wheels on the motor side are leveled horizontal, adjust if necessary.

6: Check if the guiding wheels on the return pulley are leveled horizontal, adjust if necessary.

POSITIONING THE LIMIT SWITCHES

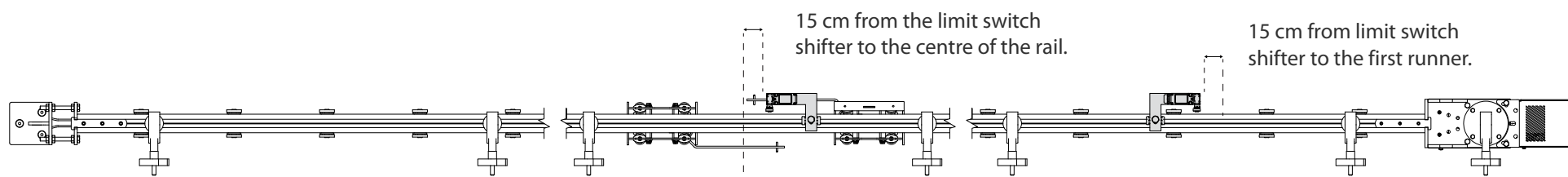

1: Slide the runners and overlap carrier towards the motor.

2: Position the limit switches as shown and according to the description on page 21.

SECURING THE LIMIT SWITCHES

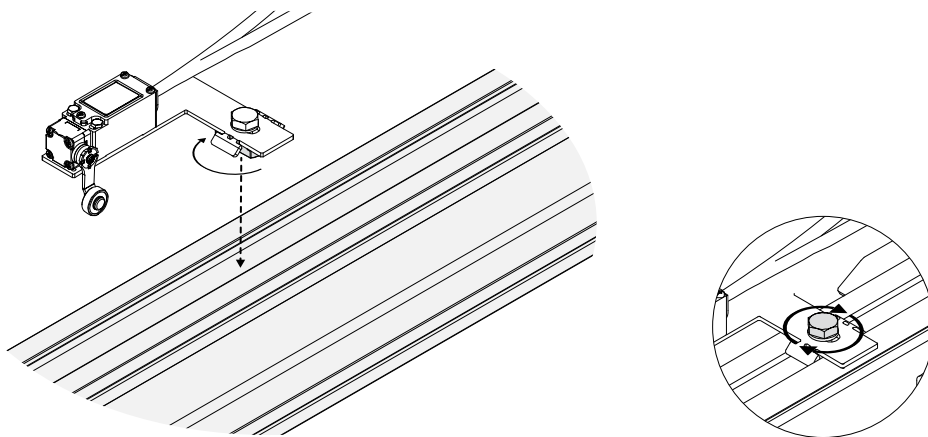

- 1: Loosen the channel nut of the limit switch & place it on the rail correctly.
- 2: Tighten the bolt to secure, refer to page 20 for correct positioning.

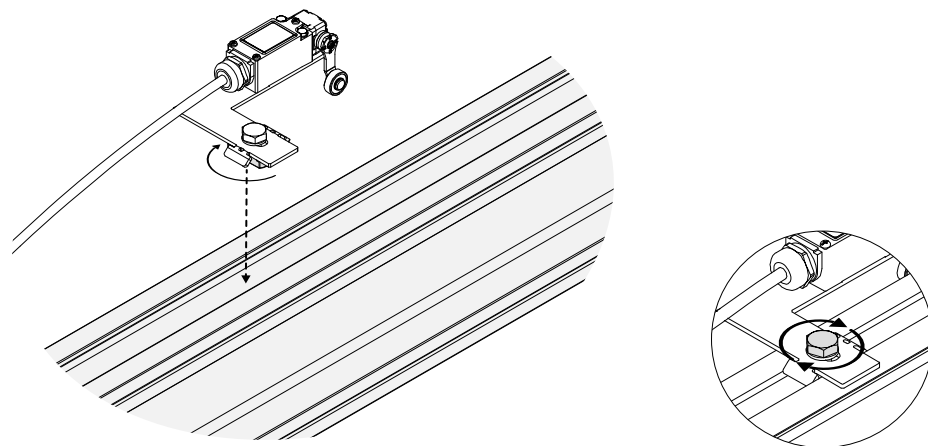

- 3: Loosen the channel nut of the 2nd limit switch & place it on the rail correctly.
- 4: Tighten the bolt to secure, refer to page 20 for correct positioning.

CONNECT THE CARRIERS TO THE CHAIN

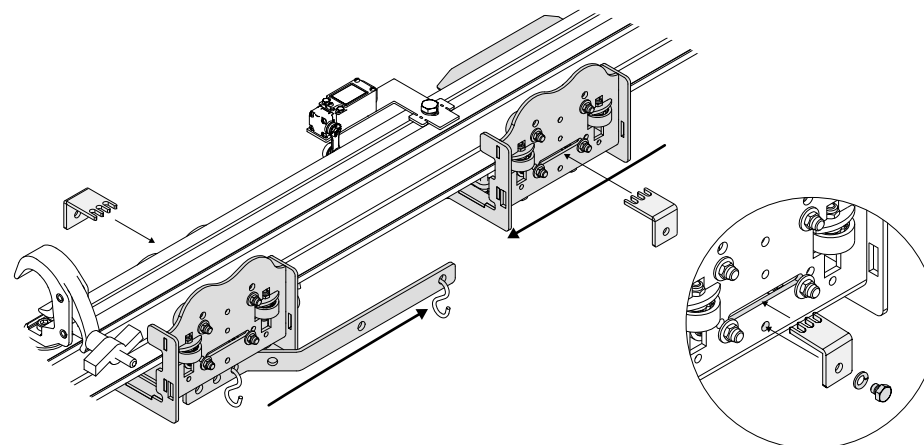

- 1: Bring back the (overlap) carriers to the centre position of the rails or stage.
- 2: Place chain links into the slit of the carriers, tighten the bolt to secure.

PLACE BACK THE PROTECTIVE PLATE

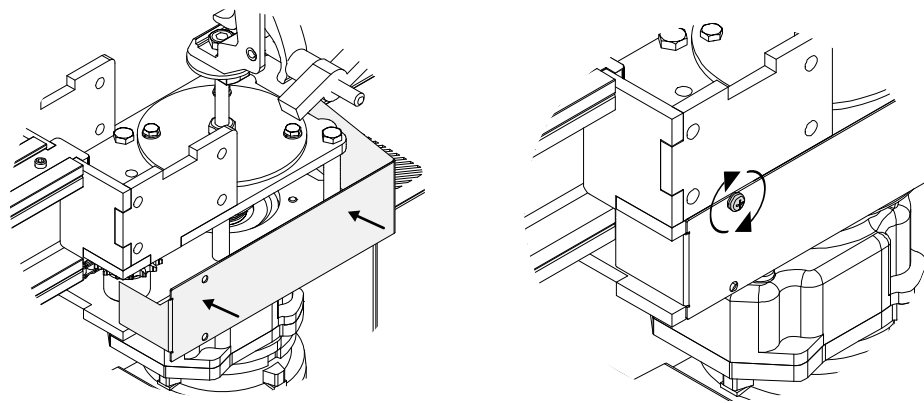

- 1: Mount the protective plate back onto the chain transmission.
- 2: Tighten the screws.

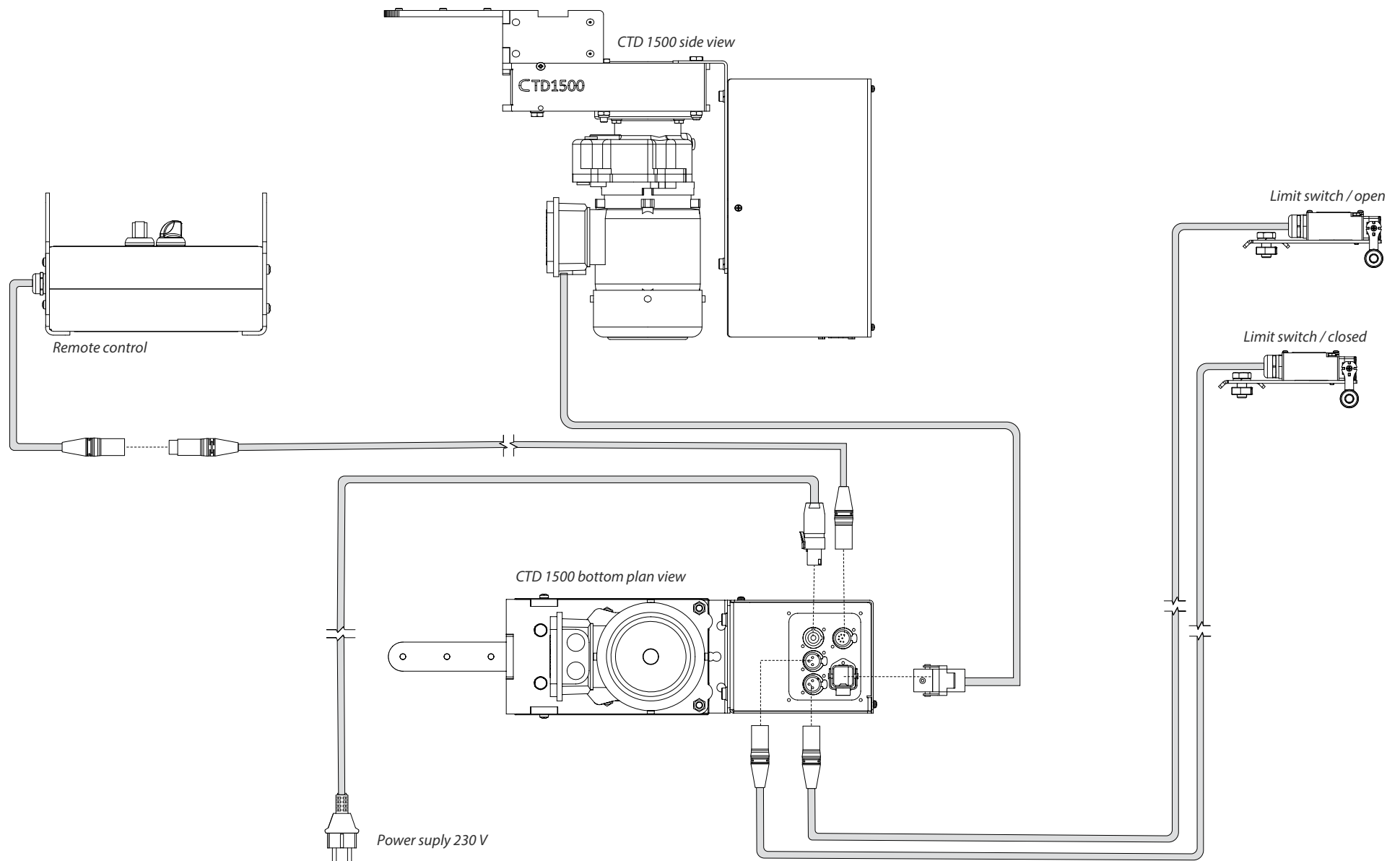

CONNECT LIMIT SWITCHES, CTD UNIT AND REMOTE CONTROL



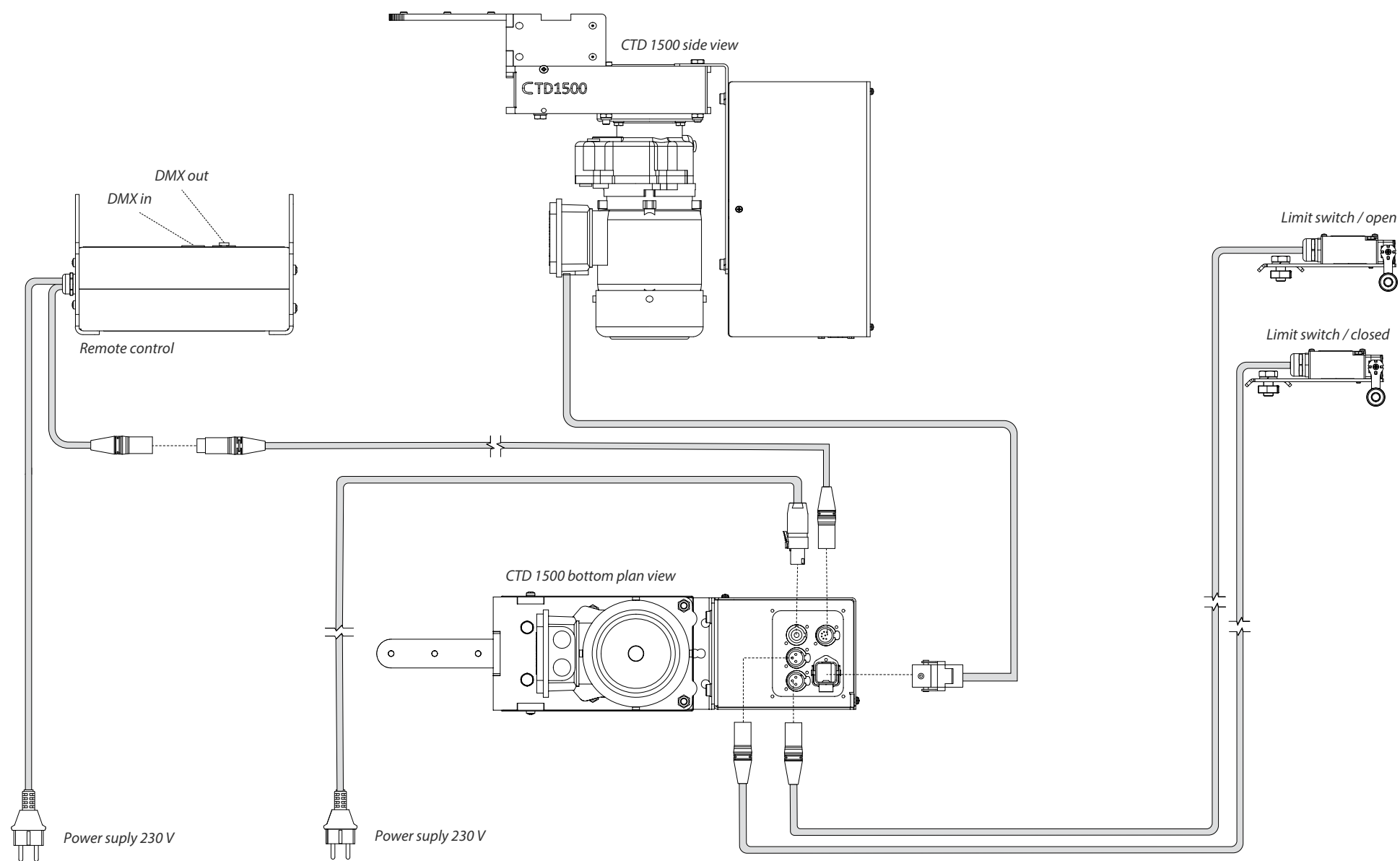







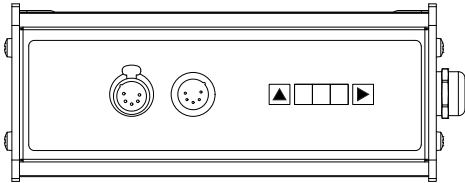

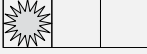

CONNECT LIMIT SWITCHES, CTD UNIT AND REMOTE CONTROL FOR DMX SETUP



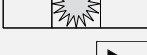

SET UP THE DMX MODULE

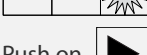
-  Scrolling thru the menu.
-  Changing the display.



SETTING OF THE DMX VALUE		
Push 1x 		The display reads Adr (after 3 seconds the display will turn off). Each DMX address has 3 values.
Push 1x 		The second digit will start blinking (after 5 sec the display will turn off).
	Push on  confirm with 	to change the value from 0 to 9 (jumps back to 0 after 9).
Push 1x 		The second digit will start blinking (after 5 sec the display will turn off).
	Push on  confirm with 	to change the value from 0 to 9 (jumps back to 0 after 9).
Push 1x 		The third digit will start blinking (after 5 sec the display will turn off).
	Push on  confirm with 	to change the value from 0 to 9 (jumps back to 0 after 9).
Confirmation of the setting, wait until REC appears on the display. The second channel will automatically follow the start address.		

SCROLLING THRU THE MENU

Push 1x 	To scroll thru the menu	
	Adr >>>>	Setting of DM address
	S1	Not applicable, has to be set to OFF To change, push on  choose between ON and OFF) and confirm with  (the display will turn off after 5 sec and the last setting will be saved)
	S2	
	S3	
	S4	
	DIS	

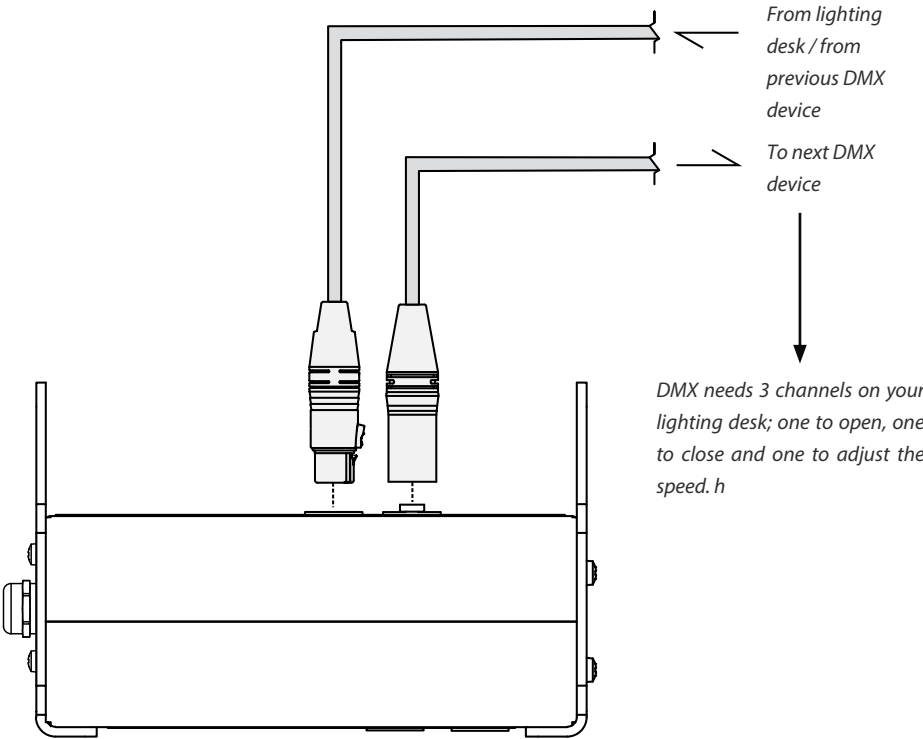

INSTALL CURTAIN

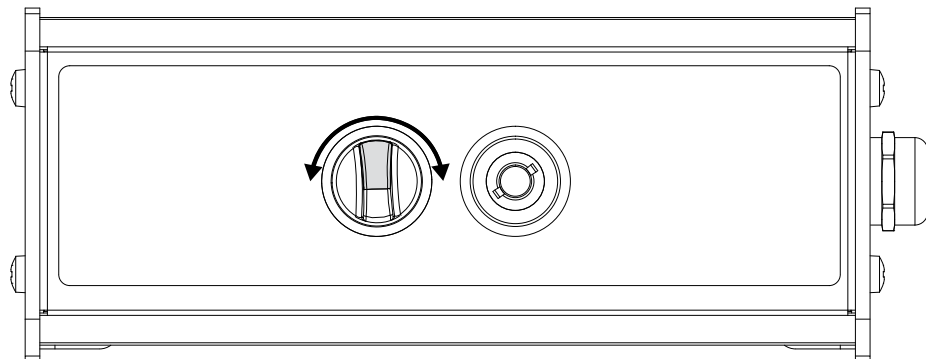

1: Check if the limit switches are plugged into the correct input (trial and error) & if the (overlap) carriers are in line with the centre of the rail or stage. Use the remote to open and close the system, if the (overlap) carriers end up at the same point as they started, your system is properly installed.

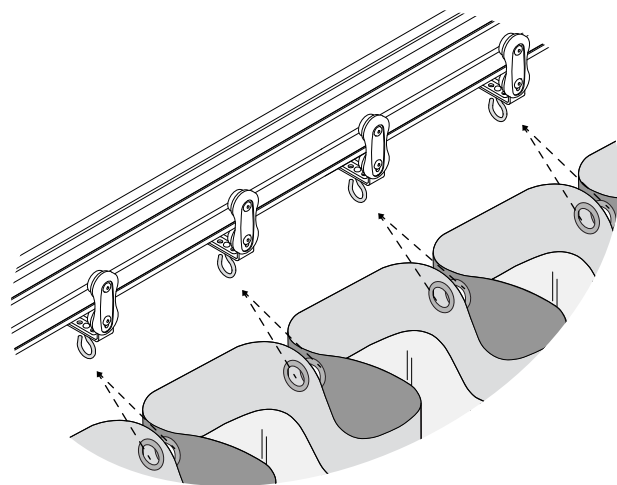

2: In order to create a pleated curtain you must take two grommets together and attach them to the same swivel hook. When you ordered a flat curtain, simply attach each grommet to a separate swivel hook.

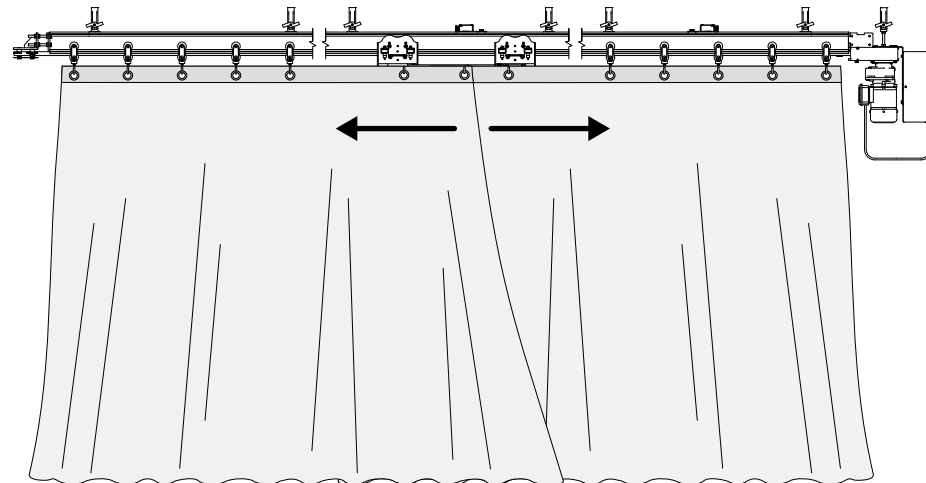

3: Hang the curtain and do a final check-up of the rail system and curtain width. Perform the test using the same method as described in the first step of this chapter.

CARE & MAINTENANCE



Periodic, regularly scheduled maintenance inspections are necessary for any mechanical system. A theatrical curtain track system is no different. It has components that must be inspected, adjusted, maintained and replaced. **In order to keep your system safe and in good working order, a regular inspection and maintenance program must be implemented.**

Please follow the schedule outlined below as a minimum maintenance programme. Once the operating personnel has had an opportunity to work with the system during the first year, certain procedures may be added or adjusted according to your facility requirements.

ITEM	w	m
Operate curtain tracks	x	
Listen for unusual carrier noise	x	
Check if curtain tracks are operating smoothly	x	
Inspect conditions of operating line (chain) and lubricate if needed		x
Inspect operating line (chain) tension		x
Listen for unusual pulley noise		x
Inspect runners, master carriers and chain links		x
Inspect curtain to carrier attachment		x
Inspect track joints for alignment		x
Inspect track channel for debris		x
Inspect attachment of track to building structure		x

** Use ShowTex aproved lubricant only / * W = every week / * M = every 6 months*

Within 24hours of using a recently installed system, confirm if the chain is tensioned correctly for curtain movement.

The best way to maintain your theatrical curtain track system, including the CTD motor unit, is by using it regularly. This will keep the grease properly distributed and allow the user to regularly check for unusual noise or drag in the system.

Above-average use or operating the curtain track at locations subject to high humidity, dust, extreme temperature changes, etc. may require shorter intervals than indicated in the scheduled programme outlined above.

TROUBLE SHOOTING

Please perform the following steps if:

IF THE CURTAIN STOPS MOVING SMOOTHLY	
1.	Check if objects are obstructing the track.
2.	Check for damage to the track, repair if this is the case.
3.	Check for debris on the track or runners, if found, remove carefully.
4.	Check for damaged runners, replace if applicable.
5.	Check connection from chainlink to chain.
6.	Check that all couplers are aligned without gaps, if not, align them.
7.	Check if the limit switches are plugged into the correct input (trail & error).

CONTACT & SUPPORT

For more technical assistance, please contact your local ShowTex branch, the address and contact information can be found on our website:

www.showtex.com